



Your Ref:

Officer: John McNab

Our Ref:

Telephone: 01252 398886

As Addressed

Email: john.mcnab@rushmoor.gov.uk

Date: 04th July 2014

Dear Sir / Madam,

CAB SHARING & AIRSHOW TRAFFIC MANAGEMENT ARRANGEMENTS FARNBOROUGH INTERNATIONAL AIRSHOW – 14th to 20th JULY 2014

As a major regional event, I write to advise you about the pick-up and drop-off points for taxis and private hire vehicles, together with the general traffic management arrangements that will operate in our area during the Farnborough International Airshow 2014 (FIA14) (14th July to 20th July 2014).

In an effort to help minimise traffic congestion, disruption, and ensure a smooth running event, I would be grateful if you would cascade this information to the various taxi and private hire services that you may regulate through your taxi licensing service.

GENERAL TRAFFIC MANAGEMENT ARRANGEMENTS

During the Airshow, a number of one-way systems, road closures and other restrictions will be put in place across the area. These general arrangements will largely be the same as those implemented during the last Airshow in 2012 and are outlined in the attached summary.

Further details of these traffic management arrangements, together with a copy of the relevant Traffic Management Order(s) can be found on our website at <http://www.rushmoor.gov.uk/article/5144/Farnborough-International-Airshow-traffic-information>.

SPECIFIC ARRANGEMENTS FOR PRIVATE HIRE VEHICLES

(see attached site plan with key markers for reference)

Site Access and Customer drop-off and pick up points

Private hire vehicles (minicabs) and out-of-borough cabs etc will **not** generally be permitted access to the Airshow site. A customer drop-off and pick-up point will be made available in RAE Road (accessible off the A325* Farnborough Road). Please note that due to the anticipated volume of vehicular traffic expected, a maximum waiting time of 20 minutes will be enforced in this area and this will be marshaled by Airshow Security and Traffic teams.

***NB:** Due to other traffic management arrangements for the Airshow, there will be no right turn off the Farnborough Road (A325) into RAE Road (i.e. when heading in the direction of Aldershot). Access to RAE Road will only be permissible via a left turn from the Farnborough Road (A325) on its approach to Farnborough town centre.

Private Hire Vehicle Parking

Private hire vehicles and executive hire services etc that have been booked for the day and need to park between service runs are encouraged to park in an allocated parking area on the Queens Parade playing fields (located off the Farnborough Road (A325)).

Use of Osborne Road / Cross Street

While used in past Airshow's, the intersection of Osborne Road and Cross Street, Farnborough will **not** be available for use as a taxi rank, drop-off or pick-up point.

In an effort to minimise disruption and the impact on local residents, this area and adjoining streets will be subject to various road closures during the Airshow. Please note that enforcement officers will be operational in the area and you will not be permitted to wait for bookings in this area. Licensed vehicles and executive services are encouraged to use the alternative parking / waiting, drop-off and pick-up arrangements outlined above.

LOCAL HACKNEY CARRIAGE CAB SHARING SCHEME

(For information only)

As in previous years, Rushmoor Borough Council has established and implemented a cab-sharing scheme for local hackney carriage vehicles (taxis) for the duration of FIA14.

While a copy of the scheme is available for viewing on our website (www.rushmor.gov.uk), the scheme is established only for local hackney carriage (taxis) journeys that run between the existing rank at Farnborough main-line station and a temporary taxi rank and drop-off point that will be established on the Airshow site.

The scheme provides that taxi passengers who wish to share a taxi vehicle between these points can do so on a flat fare basis to be charged £4.00 (maximum) per person up to a maximum of 4 (four) people in each cab. However, the scheme also maintains the existing right of the hirer of any taxi to demand an exclusive service and to be carried to any place at the metered rate in the normal way.

The temporary taxi rank and taxi drop-off point will only be accessible by locally licensed hackney carriages (taxis) that display a bona fide Airshow vehicle pass in the windscreen of their vehicle. The vehicle passes will be distributed by the Council and are provided for the sole use of RBC licensed hackney carriage (taxi) vehicles only. They are **not** transferable.

I trust the above matters are self-explanatory and meet with your satisfaction. However, should you have any query or require any further information regarding any of the above matters, I also attach a list of useful contact details for your use as may be appropriate.

Yours faithfully



JOHN McNAB
Environmental Health Manager (Licensing)
Environmental Health Services
licensing@rushmoor.gov.uk

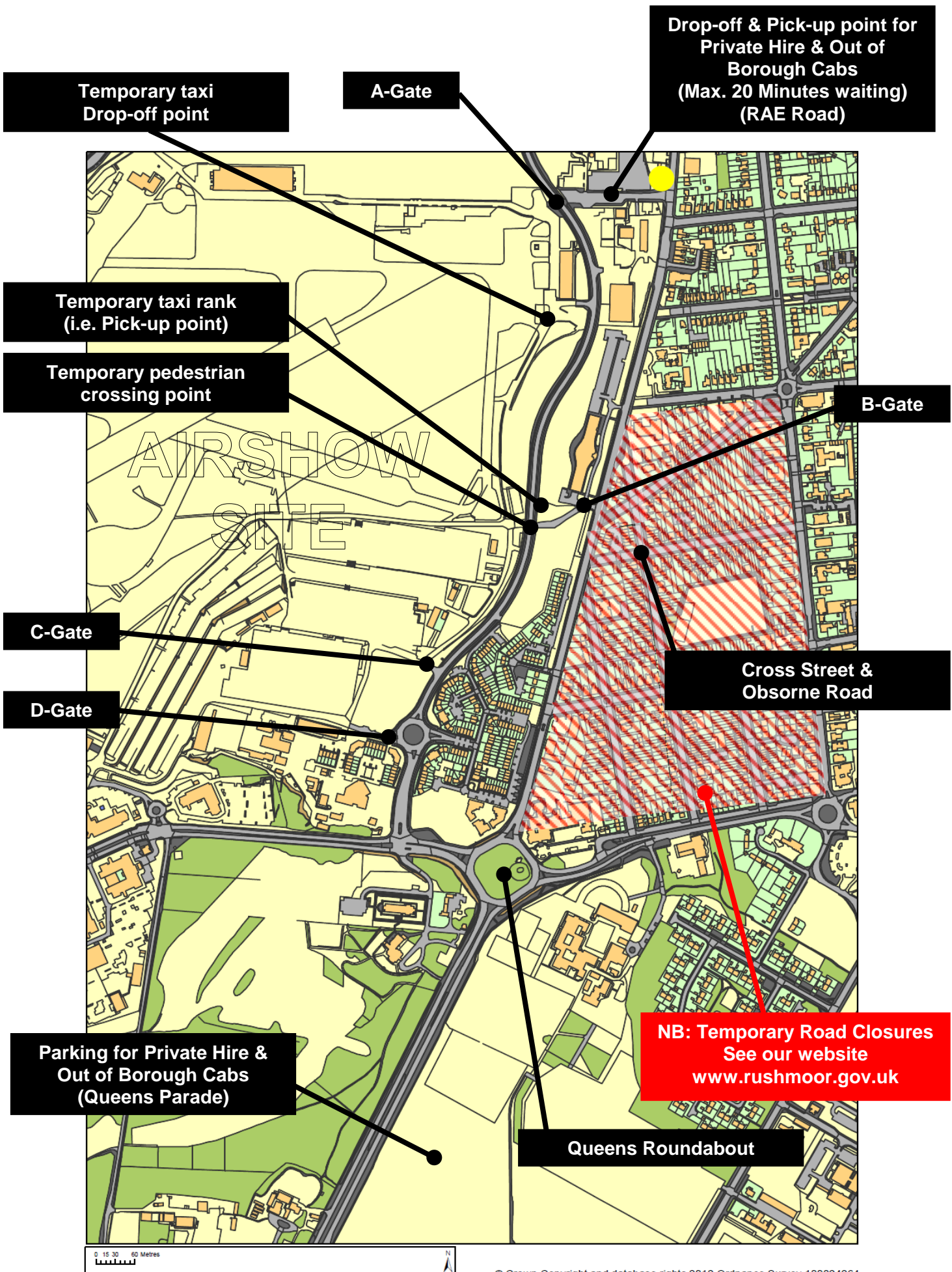

SITE PLAN & KEY MARKERS

USEFUL CONTACT DETAILS

For **Airshow enquiries** -
(c/o Farnborough International Ltd (Airshow organisers))

Email: enquiries@farnborough.com

Tel: 01252 532800

For **street parking** issues –
(c/o Rushmoor Borough Council Customer Services)

Email: customerservices@rushmoor.gov.uk

Tel: 01252 398399

For **traffic management** issues –
(c/o Rushmoor Borough Council Traffic Management Team)

Email: traffic.management@rushmoor.gov.uk

Tel: 01252 398377

For **highway** issues –
(c/o Hampshire County Council)

Email: roads@hants.gov.uk

Tel: 0845 603 5633

For **taxi and private hire licensing** issues –
(c/o Rushmoor Borough Council Licensing Team)

Email: licensing@rushmoor.gov.uk

Tel: 01252 398855

Summary of Traffic Management Arrangements during Farnborough International Airshow 2014

This year's Farnborough Airshow runs from Monday 14 July to Sunday 20 July. During the show, a number of one-way systems, road closures and other restrictions will be in place. These arrangements are the same as the last Airshow held in 2012.

Park Road one-way system 13 to 20 July

From midday on Sunday 13 July to 10pm on Sunday 20 July, the Park Road one-way system (from its junction with Reading Road to its junction with Lynchford Road), will be reversed. See diagram below (copies available at <http://www.rushmoor.gov.uk/trafficregulationorders>).

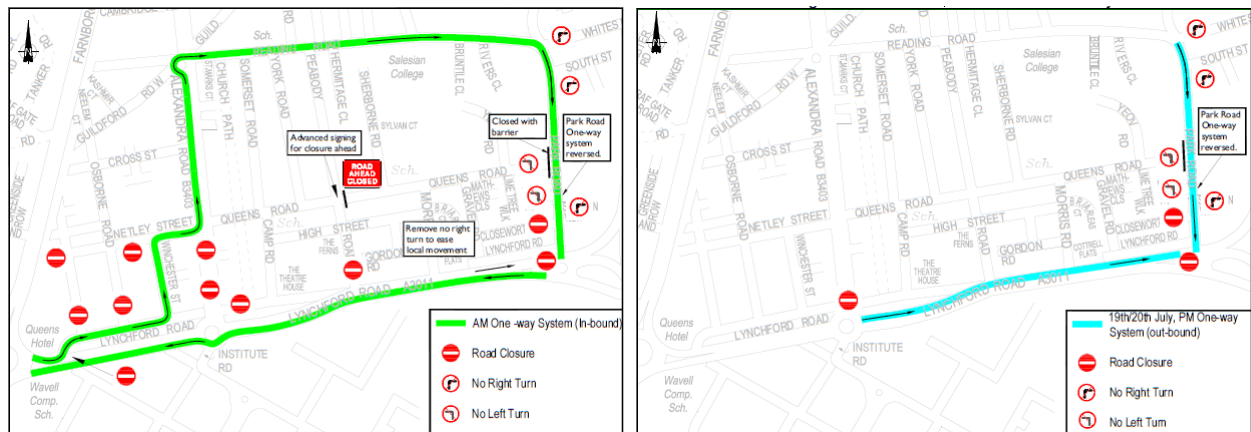

Lynchford Road one-way system 14 to 20 July (7am - 2pm)

A one-way system will run on the A3011 Lynchford Road towards the airfield. Traffic heading away from the Airshow will be diverted along Old Lynchford Road, Winchester Street, Netley Street, Alexandra Road, Reading Road and Park Road. It is expected that the diversion will be removed by midday daily. However, this will depend on the amount of traffic entering the show.

During the diversion, the western end of Old Lynchford Road (from the junction with Lynchford Road to its junction with Winchester Street) will be made one-way to ease the traffic flow.

Lynchford Road one-way system 19 to 20 July (3pm - 8pm)

A one-way system will run on the A3011 Lynchford Road away from the airfield between its junction with Alexandra Road and its junction with the Lynchford interchange (A331). See diagram above (copies available at <http://www.rushmoor.gov.uk/trafficregulationorders>).

Road closures

The following road closures will take place at the same time as the west bound Lynchford Road one-way system from 14 July to 20 July (between 7am and 2pm):

- Netley Street at its junction with Winchester Street
- Lynchford Road at its junction with Old Lynchford Road (western end)
- Southampton Street at its junction with Old Lynchford Road
- Osborne Road at its junction with Old Lynchford Road
- Peabody Road at its junction with Lynchford Road

The following road closures will take place at the same time as the east bound Lynchford Road one-way system on 19 and 20 July (between 3pm and 8pm):

- Alexandra Road at its junction with Lynchford Road
- A331 northbound Blackwater Valley Road off-slip at Lynchford interchange
- A331 southbound off-slip at Lynchford interchange junction with Lynchford Road (flyover)

The following road closures will take place for the whole Airshow week:

- Netley Street at its junction with the A325 Farnborough Road
- Church Road West at its junction with the A325 Farnborough Rd
- Queens Road at its junction with Peabody Road
- Closeworth Road at its junction with Park Road
- Lynchford Road at its junction with Park Road (Northbound only)

Ban on turns

Between 14 July and 20 July, the following movements will not be permitted:

- All right hand turns on the A325 Farnborough Road between its junction with Boundary Road to its junction with Lynchford Road (Queens Roundabout)
- Right hand turns from Salesian View, South Street, and Whites Road onto Park Road
- Left hand turns from Falkland Court and Lynchford Road onto Park Road

From 7am until 2pm between 14 July and 20 July, the following movements will not be permitted:

- Right hand turn from Alexandra Road into Netley Street
- Right hand turn from Netley Street into Alexandra Road
- Right hand turn from Alexandra Road into Queens Road
- Right hand turn from Queens Road into Alexandra Road

From 3pm until 8pm on the 19 and 20 July, the following movements will not be permitted:

- Right hand turn from Peabody Road and Morris Road into Lynchford Road

Other restrictions

As well as the restrictions above, other restrictions may apply throughout the week of the show. You will find details of these restrictions on our website at <http://www.rushmoor.gov.uk/trafficregulationorders>.

Parking restrictions

As there is likely to be extra parking in residential streets around the airfield, extra parking restrictions will be in place to reduce congestion on the major routes and in some of the residential roads near the show.

Alternative routes for local traffic

Traffic travelling both north and south in Farnborough is encouraged to use Alexandra Road (B3403).

Traffic between the A31 at Runfold, near Farnham and junction four of the M3 is encouraged to use the A331 Blackwater Valley Relief Road (BVR).

-oOo-